



# Completion Report

HHIP-Myatt Homeland Housing and Infrastructure Upgrades 2023/25

MHHU00003

- ◆ DEFENCE
- ◆ ELECTRICAL
- ◆ SMART ENERGY
- ◆ CONSTRUCTION

POWERING COMMUNITIES ◆ EMPOWERING PEOPLE

Homelands Housing and Infrastructure Program  
Department of Territory Families, Housing and Communities  
E: [HHIP.HousingInfrastructureProgram@nt.gov.au](mailto:HHIP.HousingInfrastructureProgram@nt.gov.au)

3<sup>rd</sup> October 2024

Re: HHIP – Myatt Homeland Housing and Infrastructure Upgrades – MHHU00003

On behalf of Dice (Aust) I would like to thank you for the opportunity to provide our Completion Report for the Myatt Homeland Housing and Infrastructure Upgrade works House 1.

The information compiled within this report is made with reference to the proposed scope of work that was approved by the TFHC and direct consultation with the Residents of each dwelling

This report will detail the completed works in reference to the proposed Scope of Works provided. There will be supporting documentation as per below.

- Building Declaration
- Waterproofing Declaration
- Plumbing Declaration
- Electrical Certificate of Compliance
- Photos of works completed.

## Details

### Project

The housing and infrastructure upgrades primarily focus on the repair and or replacement of health hardware for the purpose of ensuring houses in the homelands are safe and occupants have the ability to carry out healthy living practices (HLPs). The upgrades should focus firstly on safety and identifying urgent repairs and maintenance to housing and infrastructure. Secondly, the upgrades will improve the functionality of health hardware in houses in relation to whether it can support HLPs.

The priorities are:

#### **Improving healthy homes**

- Safety
- Healthy living practices.
  1. washing people
  2. washing clothes and bedding
  3. remove waste safely
  4. reduce overcrowding
  5. improving nutrition
  6. reduce the impact of animals, vermin or insects

7. reduce dust
8. controlling temperature
9. reduce trauma (potential accidents)

### **Improving local jobs and local decisions**

The program will also contribute to the following outcomes:

- Community members have the opportunity and are encouraged to participate and contribute to local decision making within their community.
- Overall the quality of housing and infrastructure in the communities is improved.
- Employment and training opportunities for local residents.
- The use of local businesses to deliver goods and services through potential subcontracting arrangements is maximised.

House 1 is permanently resided [REDACTED] the dwelling is a 4 bedroom 2 shower and 2 toilet residence, there are currently 4 adults and 4 children staying here and they were happy to move in with family for the duration of the upgrade works.

[REDACTED] requested that if she could extend her kitchen bench and change her bath/shower to a shower only that she would be very happy, she also requested that we provide some weatherproofing to the exterior laundry, to shield from sun and rain. Fortunately, we were able to deliver this request and transform the house into something that they will be able to enjoy for many years. They have also requested to paint some internal walls of their choice in colour, we have agreed to get a colour sample and return to deliver this request.

We also had the opportunity to gift these houses with a new 500ltr fridge/freezer and an 8kg top loader washing machine.

The residents were very easy and accommodating to our request and have been a pleasure to work with over the last few months, and we look forward to working with them in the future.

Please see before and after images below.

# DICE Construction & Site Office Layout

I give permission to DICE (Aust) Pty Ltd to place storage container on site as pictured to complete the upgrade work to the Myatt Homeland.

Myatt Homeland Representative:  
 Name:

Signature:

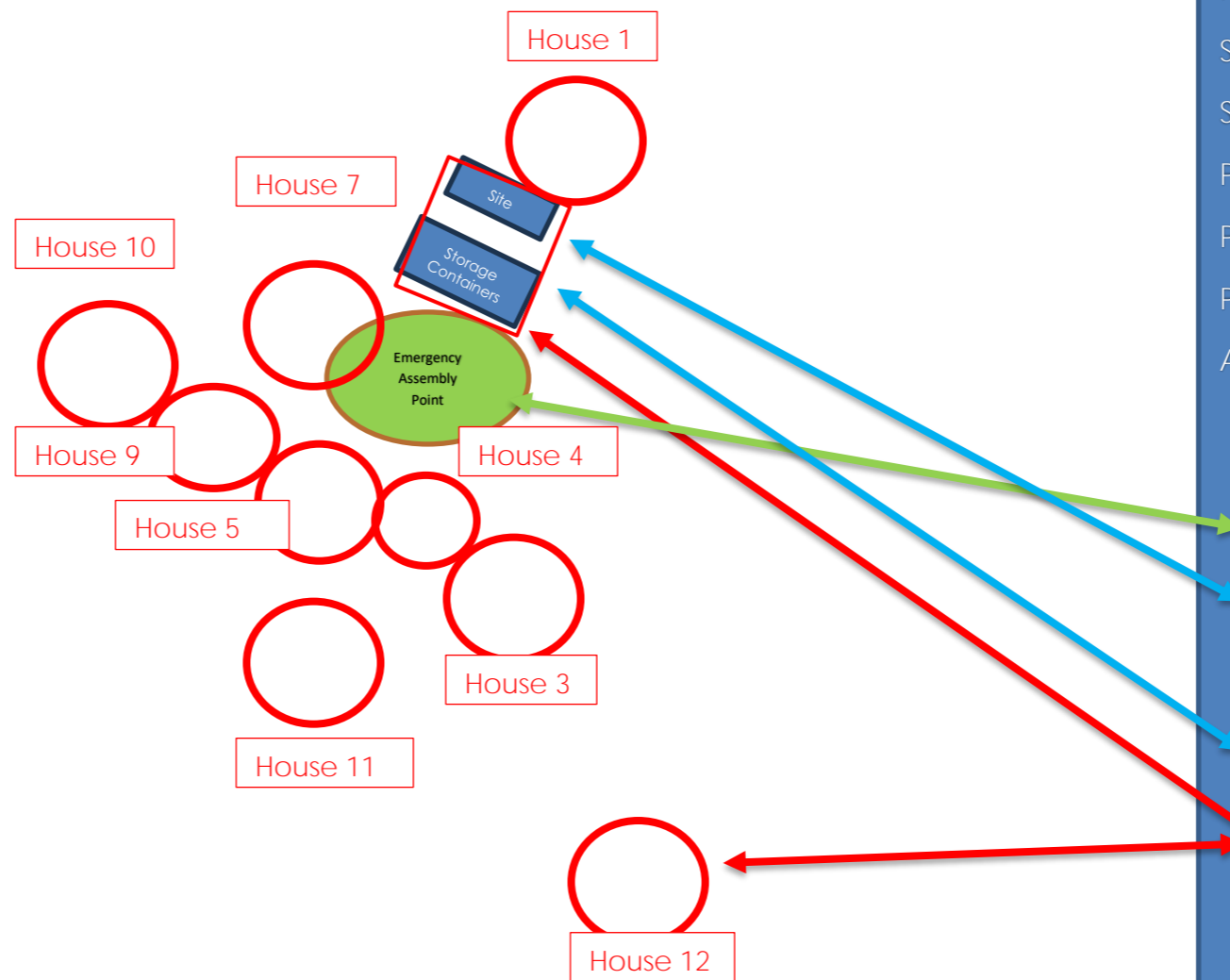

Builder: DICE (Aust) Pty Ltd  
 Project No: MHHU00003  
 Site Address: Myatt Homeland ID - 678  
 Site Supervisor: Bill McCardle  
 Phone: 0436 967 215  
 Project Manager: Jason Roe  
 Phone: 0438 283 615  
 A/H Contact: 0448 428 816

- Emergency Assembly Point
- Site Office
- Toilet – Located 6klm in Timber Creek
- Parking
- Construction Area

## **HHIP – Myatt Homeland Housing and Infrastructure Upgrades MHHU00003**

### Scope of Works - House 1 – Myatt 678



## Description

### GENERAL

#### Re-paint all previously painted surfaces

- Internal
- External
- External Steel Work (Structural) including clothesline
- Rewire clothesline (7mtr x 4 lines)

#### COC Compliance Check including earth stake

- Provide compliance check including testing of all circuits, RCDS, cables, etc including earth stake

#### Cleaning

- Provide Industrial clean - Internal
- Provide Industrial clean - Internal - material
- Provide Industrial clean - External
- Provide Industrial clean - External - material
- Pest and Vermin Treatment
- Cleaning of all stainless steel joinery throughout

#### Landscaping

- General Yard Clean including remove all rubbish
- Remove redundant fence post
- Mow and whipper snip lawns on completion
- Clear rubbish

#### Flooring

- Repair and seal existing vinyl flooring (multiple small holes throughout)

#### Locksmith/Key Alike

- Replace Entrance Sets and key alike

### EXISTING EXTERNAL

#### Re wire external screens

- Bedroom Windows 1800 x 1200
- Bathroom Windows 890 x 650
- Kitchen Windows 1500 x 900
- Toilet Windows 900 x 640
- Replace frame and screens to bed 2
- Living Room windows (1800 x 1200)

#### General

- Install flashing to RAC openings x 3 (500 x 800 internal)
- Replace 75 x 75 end caps
- Silicone repair to minor holes in roof
- Install balustrade to existing entrance (1200 x 1000)
- Refix steps to entrance
- Repair/Replace hardwood decking and oil
- Patch and repair multiple holes in metal cladding

**Electrical**

Replace carport light with WP LED 1200mm  
Upgrade to Distribution Board

**Plumbing**

Install mechanical protection to incoming water connections  
Replace leaking external tapware  
Clean and service solar hot water system, provide a report.

**EXISTING ENTRANCE****General**

Replace Screen Window 1780 x 1195  
Replace Screen Door (825 x 2060 opening)  
Demolish and remove existing tiling rear entry  
Lay new tiling to entrance and entry to bath and toilet  
Replace Solid core door, Privacy set, Vandal Plate & door stop

**Electrical**

Replace light with LED 1200mm

**EXISTING BED 1 - 3100 x 4000 x 2700****General**

Replace damaged FC sheet 6mm (1600 x 1200)  
Install new SS wardrobe with Shelf 1200 x 1800  
Dispose of BOX AC in window and replace (425 x 600) including new RAC frame  
Replace louver gallery and blades (1145 x 515)  
Replace Solid core door, Privacy set, Vandal Plate & door stop

**Electrical**

Replace DGPO  
Replace Ceiling Fan and Controller  
Replace lights with 1200 LED's

**EXISTING BED 2 - 3000 x 4000 x 2700****General**

Replace damaged FC sheet 6mm (1600 x 1200)  
Replace louver gallery and blades (1145 x 515)  
Install new SS wardrobe with Shelf 1200 x 1800  
Dispose of BOX AC in window and replace (425 x 600) including new RAC frame  
Replace Solid core door, Privacy set, Vandal Plate & door stop

**Electrical**

Replace DGPO  
Replace Ceiling Fan and Controller  
Replace lights with 1200 LED's

**EXISTING BED 3 - 3000 x 4000 x 2700****General**

Replace damaged FC sheet 6mm (1600 x 1200)  
Service Louver Gallery

Install new SS wardrobe with Shelf 1200 x 1800  
Dispose of BOX AC in window and replace (425 x 600) including new RAC frame  
Replace Solid core door, Privacy set, Vandal Plate & door stop

**Electrical**

Replace DGPO  
Replace Ceiling Fan and Controller  
Replace lights with 1200 LED's

**EXISTING BED 4 - 3000 x 4000 x 2700****General**

Replace damaged FC sheet 6mm (1600 x 1200)  
Service Louver Gallery  
Install new SS wardrobe with Shelf 1200 x 1800  
Dispose of BOX AC in window and replace (425 x 600) including new RAC frame  
Replace Solid core door, Privacy set, Vandal Plate & door stop

**Electrical**

Replace DGPO  
Replace Ceiling Fan and Controller  
Replace lights with 1200 LED's

**EXISTING KITCHEN****General**

Replace damaged FC sheet 6mm (2700 x 1200)  
Replace SS Kitchen L shape bench with extended option with splash back. (3300 x 1800) centre of sink at 1300 from L  
Clean SS Splash back to Stove (900 x 1500)  
Service louver gallery  
Install new SS Pantry (1000 x 1800)  
Install nib wall to kitchen 2200 x 900

**Electrical**

Replace Stove with 32amp lead  
Replace Stove, Isolator and 32amp outlet  
Replace DGPO  
Replace light with LED 1200 and switch

**Plumbing**

Install new SS mixer to sink  
Replace drain and trap to new sink  
Replace water outlets

**EXISTING LIVING 5600 x 7000 x 2700****General**

Replace damaged FC sheet 6mm (2700 x 1200)  
Replace louver gallery and blades  
Replace Solid core door, Entrance set, Vandal Plate & door stop  
Replace Screen Door (825 x 2055 opening)

Dispose of BOX AC in window and replace (425 x 600) including new RAC frame  
Install weather seal RP4

**Electrical**

Replace Ceiling Fan and Controller  
Replace DGPO  
Replace light with LED 1200 and switch  
Replace light with LED 600 and switch  
Replace smoke detector

**EXISTING HALLWAY 5100 x 1600 x 2700****General**

Replace missing manhole cover (600 x 600)  
Replace damaged FC sheet 6mm (2700 x 1200)  
Install new SS linen wardrobe (400 x 1820) open shelves

**Electrical**

Replace smoke detector

**EXISTING BATHROOM 2200 x 2000****General**

Service and Ease Solid core door, Privacy set, Vandal Plate & door stop  
Replace louver gallery and blades  
Demolish existing tiles and bathroom fixtures  
Install PVC architrave to window 25 x 10  
Room bath and prep for installation of shower only  
Replace lami panel 6mm (2400 x 1200)  
Waterproof wet area  
Install new hob for shower recess  
Retime wet area with new tiling  
Install new shaving cabinet  
Allowance to repair water damaged framing if exposed (4lm)  
Install new SS mirror

**Electrical**

Replace LED 1200 WP and Switch

**Plumbing**

Replace complete toilet and cistern  
Install new SS basin  
Install new tapware, and shower head  
Replace existing tapware with SS mixer  
Replace existing water outlets  
Replace drain and trap to new sink

**EXISTING TOILET 1200 x 2200****General**

Replace Solid core door, Entrance set, Vandal Plate & door stop  
Demolish existing tiles and toilet fixtures

Install PVC architrave to window 25 x 10  
Replace lami panel 6mm (2400 x 1200)  
Waterproof wet area  
Install new towel rack/roll holder  
Retile wet area with new tiling  
Replace louver gallery and blades (580 x 510)

**Electrical**

Replace DGPO WP  
Replace LED 1200 WP and Switch

**Plumbing**

Replace complete toilet and cistern  
Replace toilet water outlet  
Replace hand basin - small  
Install new mixer and water outlets

**EXISTING EXTERNAL SHOWER 1200 x 2200****General**

Replace Solid core door, Entrance set, Vandal Plate & door stop  
Replace louver gallery and blades (580 x 510)  
Install PVC architrave to window 25 x 10  
Demolish existing tiles and toilet fixtures  
Repair hob for shower recess  
Replace lami panel 6mm (2400 x 1200)  
Allowance to repair water damaged framing if exposed (2lm)  
Waterproof wet area  
Retile wet area with new tiling  
Install new shaving cabinet

**Electrical**

Replace DGPO WP  
Replace LED 1200 WP and Switch

**Plumbing**

Install new SS basin  
Demolish existing bath tapware and install new shower breach  
Replace existing tapware with SS mixer  
Install new tapware, and shower head  
Replace existing water outlets  
Replace drain and trap to new sink

**EXISTING EXTERNAL TOILET 1200 x 2200****General**

Replace Solid core door, Entrance set, Vandal Plate & door stop  
Demolish existing tiles and toilet fixtures  
Replace lami panel 6mm (2400 x 1200)  
Waterproof wet area

Install new towel rack/roll holder  
Retile wet area with new tiling  
Replace louver gallery and blades (580 x 510)

**Electrical**

Replace DGPO WP  
Replace LED 1200 WP and Switch

**Plumbing**

Replace complete toilet and cistern  
Replace toilet water outlet  
Replace hand basin - small  
Install new mixer and water outlets

**EXISTING EXTERIOR LAUNDRY****General**

Acid wash and clean existing SS trough  
Pressure wash existing mesh cage  
Install sheeting to wall to keep out weather 1500 x 3200

**Electrical**

Replace DGPO WP  
Replace LED 1200 WP and Switch

**Plumbing**

Replace mixer to laundry sink  
Replace washing machine tap outlets

The proposed scope above has been developed in line with the intent of this program, all items identified have been viewed as a necessary component of ensuring and encouraging healthy living practices.

All works will be delivered in accordance with the relevant Work Practices and follow the relevant Australian Standards.

At the completion and handover of each dwelling, Dice will produce the relevant supporting documentation required

Certification documentation if relevant to works.

- NT. Electrical Certificate of Compliance
- Wet Area Waterproofing Certificate.
- Glazing Certificate
- Serial No', warranties of installed appliances

If you would like clarification or further information, please don't hesitate to contact me.

Regards



Jason Roe  
Project Manager

Hand over completed in accordance with the scope provided.

Name	Delegation	Signature
Josef Kulda	Project Manager - Homelands Housing and Infrastructure Program Department of TFHC	
Paul Opden	Project Manager – Homeland Services Group Department of TFHC	
Thomas McDowall	Project Manager - Homelands Housing and Infrastructure Program Department of TFHC	
Jason Roe	Project Manager Dice (Aust Pty Ltd)	

Additional comments.

**Before and After Images House 1**











